

<b>DATI TECNICI / technical sheet</b>	<b>DISPENSER CEROTTI BOLERO</b>
	<b>plaster dispenser BOLERO</b>

93/42/CEE

**MATERIALI / components**

1	PARATIA MOBILE <i>movable section</i>	ABS <i>abs</i>
2	PARTE DI FISSAGGIO A PARETE <i>fixing wall section</i>	ABS <i>abs</i>
3	COPERCHIO TRASPARENTE <i>transparent cover</i>	K RESIN <i>k resin</i>
4	CHIAVE DI APERTURA <i>opening key</i>	POLICARBONATO <i>polycarbonate</i>
5	SERRATURA A FRECCIA <i>arrow lock</i>	POLICARBONATO <i>polycarbonate</i>
6	ASTUCCIO <i>box</i>	CARTONE PLASTIFICATO <i>plasticize cartoon</i>
7	KIT FISSAGGIO A PARETE <i>fixing wall kit</i>	VITI E TASSELLI A ESPANSIONE <i>screw and rawplug</i>
8	BI ADESIVI DI FISSAGGIO <i>fixed bi-adhesive</i>	POLIPROPILENE <i>polypropylene</i>

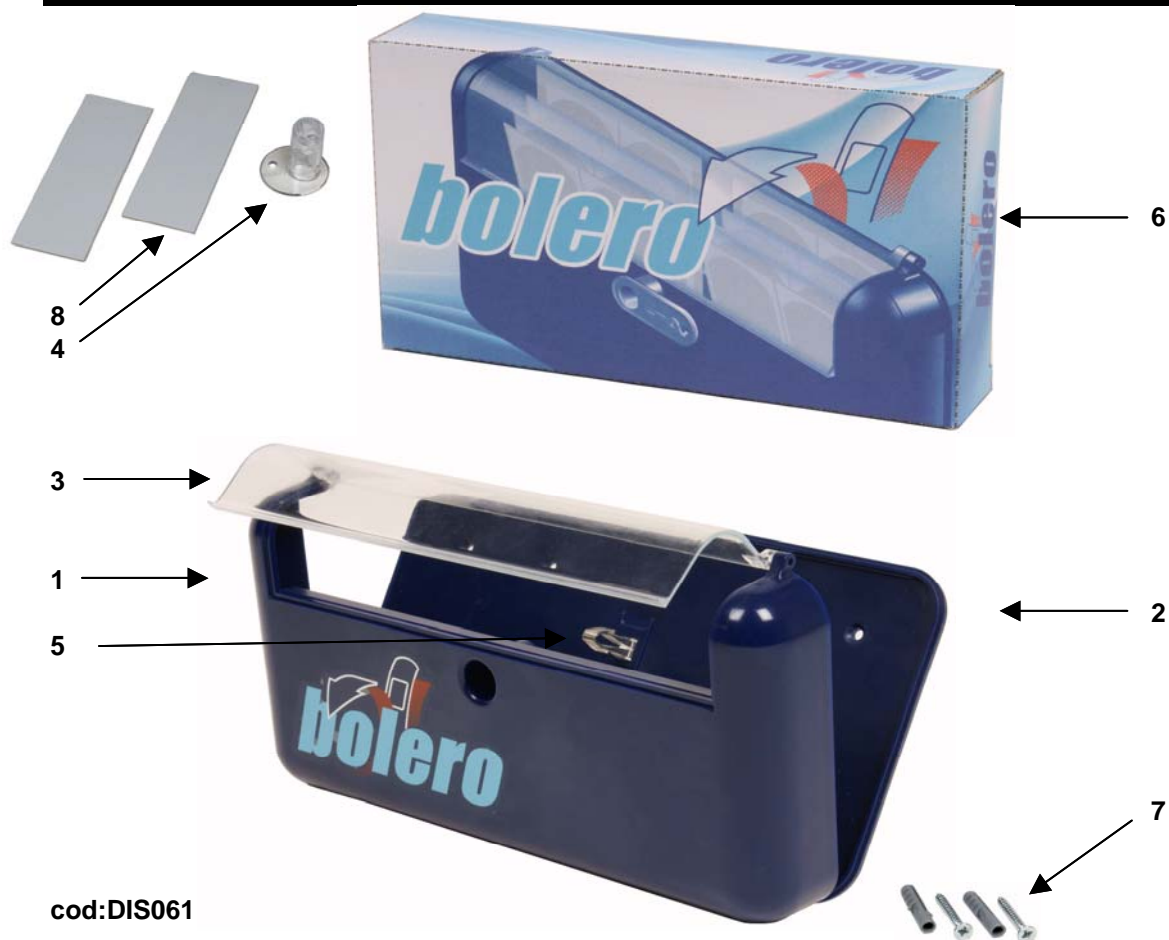

cod:DIS061

<b>PVS S.p.A. - Cassina de Pecchi - Italy</b>	<b>22/07/10</b>
---	-----------------